

Performance Valve Springs *by Engine Pro*



**NITRO BLACK BEEHIVE SPRINGS
SUPER CLEAN CHROME SILICON VANADIUM NICKEL ALLOY**

- Beehive shaped design allows a reduced retainer end mass for improved rpm potential
- Every spring goes through a multiple shot peening process to ensure maximum durability and stress relief
- "Heat Set" process and special heat treatment are used to extend spring life and minimize load loss
- Ovate wire shape more evenly distributes mass throughout the wire cross section



NITRO BLACK BEEHIVE SPRINGS

Super Clean Chrome Silicon Vanadium Nickel Alloy



- Beehive shaped design allows a reduced retainer end mass for improved rpm potential
- Every spring goes through a multiple shot peening process to ensure maximum durability and stress relief
- "Heat Set" process and special heat treatment are used to extend spring life and minimize load loss
- Ovate wire shape more evenly distributes mass throughout the wire cross section

Part #	Spring O.D. Bottom	Spring I.D. Bottom	Spring O.D. Top	Spring I.D. Top	Closed Height	Closed Load	Open Height	Open Load	Coil Bind	Max. Lift	Rate	Material Type*	Steel Retainer Number	Titanium Retainer Number
02-1200-16	1.061	0.737	0.960	0.636	1.640	80	1.090	185	1.020	.550	191	Cr-Si-V-Ni	03-1012	
02-1205-16	1.237	0.825	1.062	0.650	1.700	110	1.175	292	1.115	.575	347	Cr-Si-V-Ni	03-1011	03-1794
													03-1013	
													03-1014	
													03-1015	
02-1201-16	1.292	0.880	1.062	0.650	1.800	135	1.150	330	1.110	.650	300	Cr-Si-V-Ni	03-1011	03-1794
													03-1013	
													03-1014	
													03-1015	
02-1204-16	1.292	0.880	1.062	0.650	1.800	105	1.200	298	1.100	.625	322	Cr-Si-V-Ni	03-1011	03-1794
													03-1013	
													03-1014	
													03-1015	
02-1203-16	1.412	1.065	1.000	0.650	1.750	123	1.175	284	1.100	.650		Cr-Si-V-Ni		
02-1202-16	1.447	0.999	1.098	0.650	1.880	155	1.280	365	1.210	.600	350	Cr-Si-V-Ni	03-1011	03-1794
													03-1013	
													03-1014	
													03-1015	

*MATERIAL TYPE, Cr-Si-V-Ni = Chrome Silicon Vanadium Nickel Alloy

ENGINE PRO SUPER CLEAN STREET/RACE VALVE SPRINGS

Dual Valve Spring Assemblies

All Engine Pro valve springs are manufactured using the highest quality chrome silicon or high tensile chrome silicon vanadium alloy materials. Our springs are inspected during the manufacturing process to ensure consistent dimensions and overall quality.

- Every spring goes through a multiple shotpeening process for maximum durability and stress relief
- "Heat Set" process and special heat treatment are used to extend spring life and minimize load loss

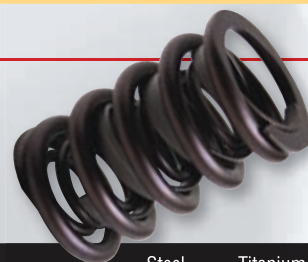

Part #	Outer Spring O.D.	Outer Spring I.D.	Inner Spring I.D.	Closed Height	Closed Load	Open Height	Open Load	Coil Bind	Max Lift	Rate	Material Type *	Damper	Steel Retainer Number	Titanium Retainer Number
02-1023-16	1.304	0.940	0.670	1.800	151	1.150	417	1.080	.650	409	Cr-Si-V	N		
02-1301-16	1.385	0.995	0.711	1.850	161	1.250	430	1.195	.600	448	Cr-Si	N		
02-1024-16	1.388	1.062	0.806	1.600	117	1.100	232	1.000	.600	230	Cr-Si-V	N	03-1003	
02-1010-16	1.440	1.076	0.697	1.700	126	1.150	364	1.055	.550	433	Cr-Si	Y	03-1006	03-1730
02-1003-16	1.445	1.085	0.697	1.750	142	1.150	349	1.055	.600	345	Cr-Si	Y	03-1006	03-1730
02-1004-16	1.445	1.085	0.696	1.750	133	1.150	316	1.055	.600	305	Cr-Si	Y	03-1006	03-1730
02-1300-16	1.450	1.060	0.790	1.900	140	1.300	358	1.120	.650	363	Cr-Si	N	03-1003	
02-1011-16	1.460	1.060	0.696	1.850	126	1.250	368	1.150	.625	403	Cr-Si	Y	03-1003	
02-1012-16	1.515	1.115	0.696	1.900	125	1.200	385	1.165	.725	371	Cr-Si	Y		
02-1015-16	1.539	1.125	0.697	1.950	145	1.350	425	1.200	.625	467	Cr-Si	Y	03-1007	
02-1008-16	1.539	1.125	0.731	1.900	206	1.250	520	1.200	.650	483	Cr-Si	Y	03-1007	03-1732
													03-1008	
02-1009-16	1.546	1.134	0.814	1.900	240	1.250	598	1.150	.650	551	Cr-Si-V	N	03-1007	
													03-1009	

*MATERIAL TYPE, Cr-Si = Chrome Silicon Alloy. Cr-Si-V= Chrome Silicon Vanadium Alloy

NEW NUMBERS SHOWN IN BOLD FACE TYPE

ENGINE PRO SUPER CLEAN STREET/RACE VALVE SPRINGS

Single Valve Springs

- Every spring goes through a multiple shotpeening process for maximum durability and stress relief
- "Heat Set" process and special heat treatment are used to extend spring life and minimize load loss



Part #	Spring O.D.	Spring I.D.	Closed Height	Closed Load	Open Height	Open Load	Coil Bind	Max. Lift	Rate	Material Type*	Damper	Steel Retainer Number	Titanium Retainer Number
02-1000-16	1.230	0.876	1.700	91	1.250	233	1.150	.525	316	Cr-Si	Y	03-1000	
												03-1001	
02-1001-16	1.253	0.870	1.700	124	1.210	322	1.160	.490	404	Cr-Si	Y	03-1000	
												03-1001	
02-1002-16	1.259	0.876	1.800	121	1.200	365	1.160	.600	407	Cr-Si	Y	03-1000	
												03-1001	
02-1016-16	1.263	0.880	1.750	150	1.250	367	1.100	.500	434	Cr-Si-V	Y	03-1000	
												03-1001	
02-1019-16	1.354	0.940	1.850	97	1.350	312	1.280	.550	430	Cr-Si	Y		
02-1017-16	1.437	1.035	1.700	110	1.200	289	1.060	.550	358	Cr-Si	Y		
02-1020-16	1.463	1.080	1.900	100	1.300	252	1.120	.650	253	Cr-Si	Y	03-1006	03-1730
02-1021-16	1.464	1.064	1.800	129	1.250	305	1.135	.550	320	Cr-Si	Y	03-1002	
												03-1003	
												03-1005	
												03-1010	
02-1005-16	1.476	1.062	1.800	109	1.300	317	1.140	.525	416	Cr-Si	Y	03-1003	
02-1022-16	1.494	1.080	1.650	106	1.250	258	1.100	.525	380	Cr-Si	Y	03-1006	03-1730
02-1018-16	1.500	1.117	1.800	152	1.250	311	1.050	.575	289	Cr-Si-V	Y	03-1004	
												03-1008	
02-1007-16	1.539	1.125	1.900	133	1.400	309	1.170	.625	352	Cr-Si	Y	03-1007	
												03-1008	
02-1014-16	1.548	1.134	1.900	150	1.350	328	1.180	.575	324	Cr-Si	Y	03-1007	
												03-1008	

*MATERIAL TYPE, Cr-Si = Chrome Silicon Alloy. Cr-Si-V= Chrome Silicon Vanadium Alloy



NEW NUMBERS SHOWN IN BOLD FACE TYPE



ENGINE PRO BRAND PRODUCTS

The Engine Pro line of engine products represents one of the best values available. Every Engine Pro part is manufactured with precision to meet the highest standards in the industry. Whether for stock, street or high performance applications, Engine Pro products are priced to give engine professionals the ability to install the highest quality, most reliable engine parts every time. For full descriptions and complete application charts log onto www.goenginepro.com.

NEW NUMBERS SHOWN IN BOLD FACE TYPE

10° TITANIUM VALVE SPRING RETAINERS

Engine Pro titanium valve spring retainers are engineered to perform under the most extreme conditions and are inspected to ensure precise tolerances.

- Manufactured from 6AL4V titanium alloy
- Made in the USA - your assurance of quality
- Light weight
- Machined and polished finish
- Call for other sizes and applications

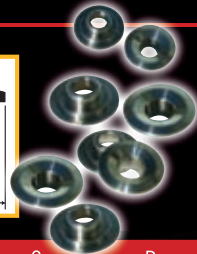
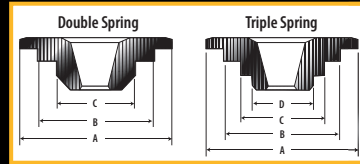

PART #	SPRING O.D.	SPRING TYPE	VALVE STEM SIZE	A	B	C	D
03-1730-16	1.437 / 1.500	DOUBLE	ALL	1.437	1.065	.700	
03-1731-16	1.500 / 1.550	DOUBLE	ALL	1.437	1.100	.800	
03-1732-16	1.500 / 1.550	DOUBLE	ALL	1.500	1.110	.710	
03-1733-16	1.625	DOUBLE	ALL	1.500	1.180	.765	
03-1736-16	1.500 / 1.550	TRIPLE	ALL	1.500	1.135	.835	.635
03-1739-16	1.625	TRIPLE	ALL	1.500	1.180	.870	.635
03-1735-16*	1.625	TRIPLE	ALL	1.500	1.180	.870	.635
03-1794-16	1.300	BEEHIVE	ALL	1.050	.640		

*+.050 INSTALLED HEIGHT OVER # 03-1739

STEEL VALVE SPRING RETAINERS

Engine Pro chrome moly steel retainers are designed to handle high pressures developed by new large diameter valve springs. Our retainers are manufactured to precise tolerances to ensure the springs are located properly. Available for 7 degree and 10 degree valve locks.

- 4140 chrome moly steel alloy
- CNC machined
- Heat treated
- Black oxide finish

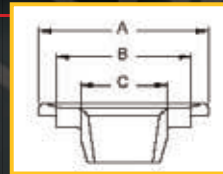

PART #	SPRING O.D.	SPRING HEIGHT	KEEPER DEGREE	VALVE STEM SIZE	A	DIMENSIONS B	C
03-1000-16	1.250	STD	7	11/32"	1.245	.865	.680
03-1001-16	1.250	+.050	7	11/32"	1.245	.865	.680
03-1017-16	1.275/1.325	STD	7	8mm	1.240	.940	.640
03-1003-16	1.437/1.550	STD	7	11/32"	1.440	1.050	.700
03-1002-16	1.437/1.550	STD	10	ALL	1.440	1.050	.700
03-1005-16	1.437/1.550	STD	7	3/8"	1.440	1.050	.700
03-1006-16	1.437/1.500	STD	10	ALL	1.400	1.060	.690
03-1004-16	1.500/1.550	STD	10	ALL	1.437	1.100	.800
03-1007-16	1.500/1.550	+.100	10	ALL	1.500	1.115	.690
03-1008-16	1.550	+.100	10	ALL	1.500	1.105	.710
03-1009-16	1.550	+.100	10	ALL	1.500	1.120	.705
03-1010-16	1.437/1.550	+.100	7	11/32"	1.440	1.050	.700
03-1011-16	1.055	STD	7	8mm	1.030	0.640	BEEHIVE
03-1012-16	.959	STD	7	STOCK	0.930	0.630	BEEHIVE
03-1013-16	1.055	STD	7	11/32"	1.030	0.640	BEEHIVE
03-1014-16	1.095	STD	10	ALL	1.050	0.640	BEEHIVE
03-1015-16 *	1.055	STD	7	8mm	1.030	0.640	BEEHIVE
03-1016-16	1.437/1.500	STD	7	11/32"	1.400	1.030	.690

* SAME AS 03-1011 BUT I.D. IS MACHINED FOR ADDITIONAL VALVE GUIDE CLEARANCE.

For complete list of applications, contact your Engine Pro distributor or log onto www.enginepro.com

Engine Pro™ and the Engine Pro "E" logo are registered trademarks of Engine Parts Group, Inc. All Rights Reserved.